

FLOOR PLANS





PORTALEN

BONNIER FASTIGHETER

GROUND FLOOR

COLOR CODE AND FUNCTIONS

Area 1549 sq.m.

-  Entrance / Lobby, 178 sq.m.
-  Shared meeting space with associated service areas, 186 sq.m.
 - meeting room with 8 seats (2 rooms)
 - meeting room with 2 seats (1 room)
 - meeting room with the possibility of auditorium disposition with 25 seats (1 room)
-  Changing room with shower and WC (2 rooms) / bicycle facilities (1 room)
-  Restaurant with related service areas with approx. 115 seats, 516 sq.m.

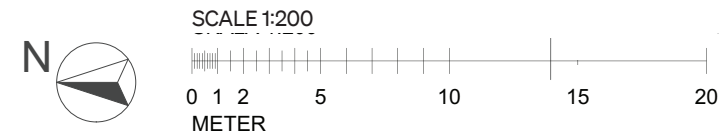

* The property owner reserves the right for changes, printing errors or incorrect information in this document. The floor plans are suggestions that may deviate from reality.

PORTALEN

BONNIER FASTIGHETER

FLOOR 1, 2, 3

LAYOUT EXAMPLE, SCANDINAVIAN STYLE

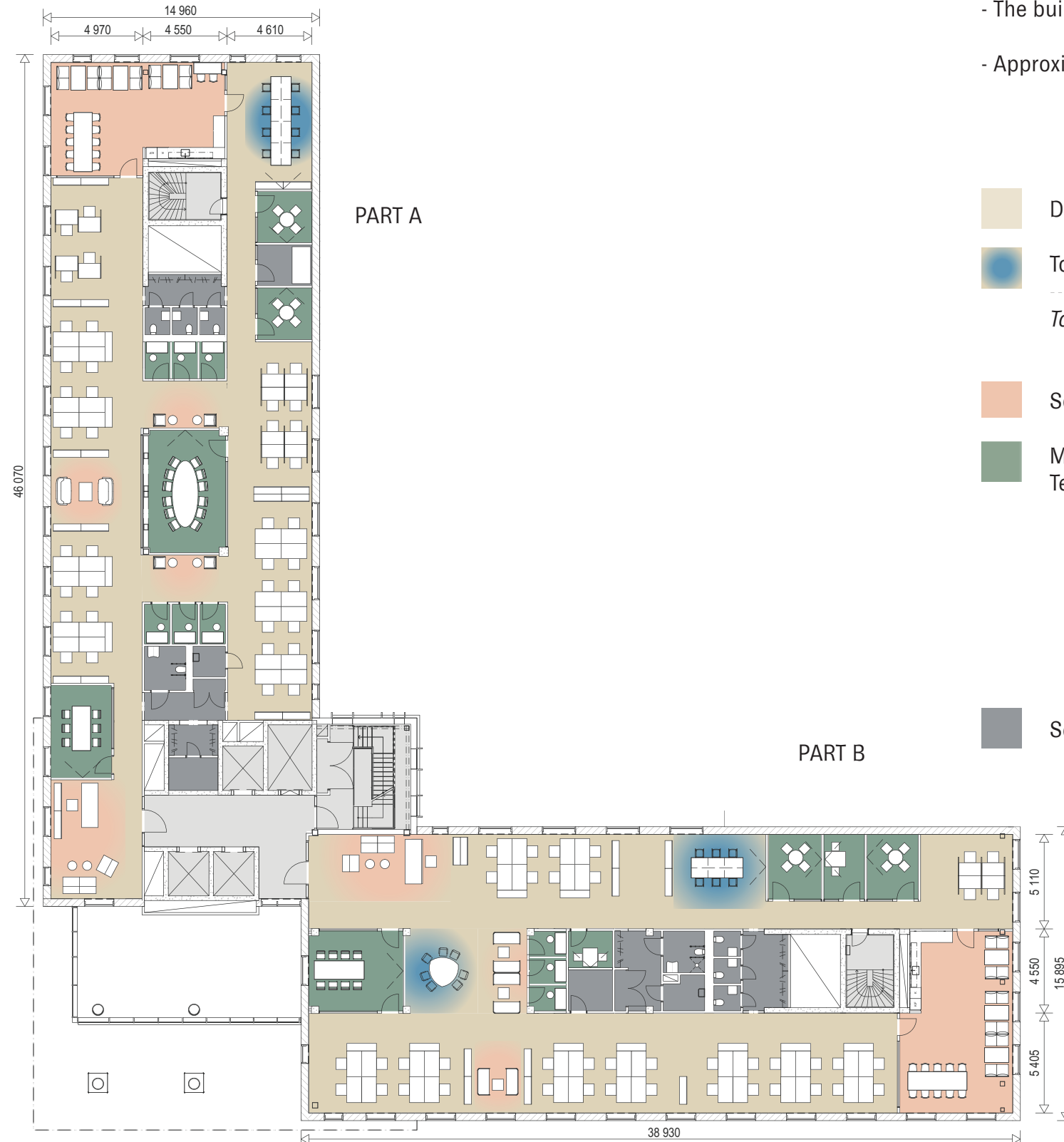

COLOR CODE AND FUNCTIONS

- Area 1075 sq.m. (Part A: 532 sq.m., Part B: 543 sq.m.)

- The building and each floor is dimensioned for a maximum of 10 sq.m./person

- Approximate room height: office landscape 2900 mm, circulation space/meeting room 2600 mm

	PART A+B	Part A	Part B
Desks in open plan	80 seats	40 seats	40 seats
Touchdown seats	21 seats	8 seats	13 seats
<i>Total</i>	101 seats	<i>48 seats</i>	<i>53 seats</i>
Social area	70 seats	35 seats	35 seats
Meeting rooms Telephone rooms			
	12 seats	1 room	1 room
	8 seats	1 room	1 room
	6 seats	1 room	1 room
	4 seats	4 rooms	2 rooms
	2 seats	2 rooms	2 rooms
	1 seat	9 rooms	6 rooms
Service / WC (8) / Copy room (1) / Quiet room (1) / Kitchenettes (2)			



SCALE 1:200

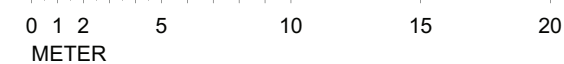

* The property owner reserves the right for changes, printing errors or incorrect information in this document. The floor plans are suggestions that may deviate from reality.

PORTALEN

BONNIER FASTIGHETER

FLOOR 1, 2, 3

LAYOUT EXAMPLE, INDUSTRIAL STYLE



COLOR CODE AND FUNCTIONS

- Area 1075 sq.m. (Part A: 532 sq.m., Part B: 543 sq.m.)

- The building and each floor is dimensioned for a maximum of 10 sq.m./person

- Approximate room height: office landscape 2900 mm, circulation space/meeting room 2600 mm

	Part A+B	Part A	Part B
Desks in open plan	20 seats	12 seats	8 seats
Touchdown seats	82 seats	38 seats	44 seats
<i>Total</i>	102 seats	<i>50 seats</i>	<i>52 seats</i>
Social area	91 seats	41 seats	50 seats
Meeting rooms Telephone rooms			
	12 seats	1 room	1 room
	8 seats	1 room	1 room
	6 seats	1 room	1 room
	4 seats	4 rooms	2 rooms
	2 seats	2 rooms	2 rooms
	1 seat	9 rooms	6 rooms
Service / WC (8) / Copy room (1) / Quiet room (1) / Kitchenette (2)			3 rooms



* The property owner reserves the right for changes, printing errors or incorrect information in this document. The floor plans are suggestions that may deviate from reality.

PORTALEN

BONNIER FASTIGHETER

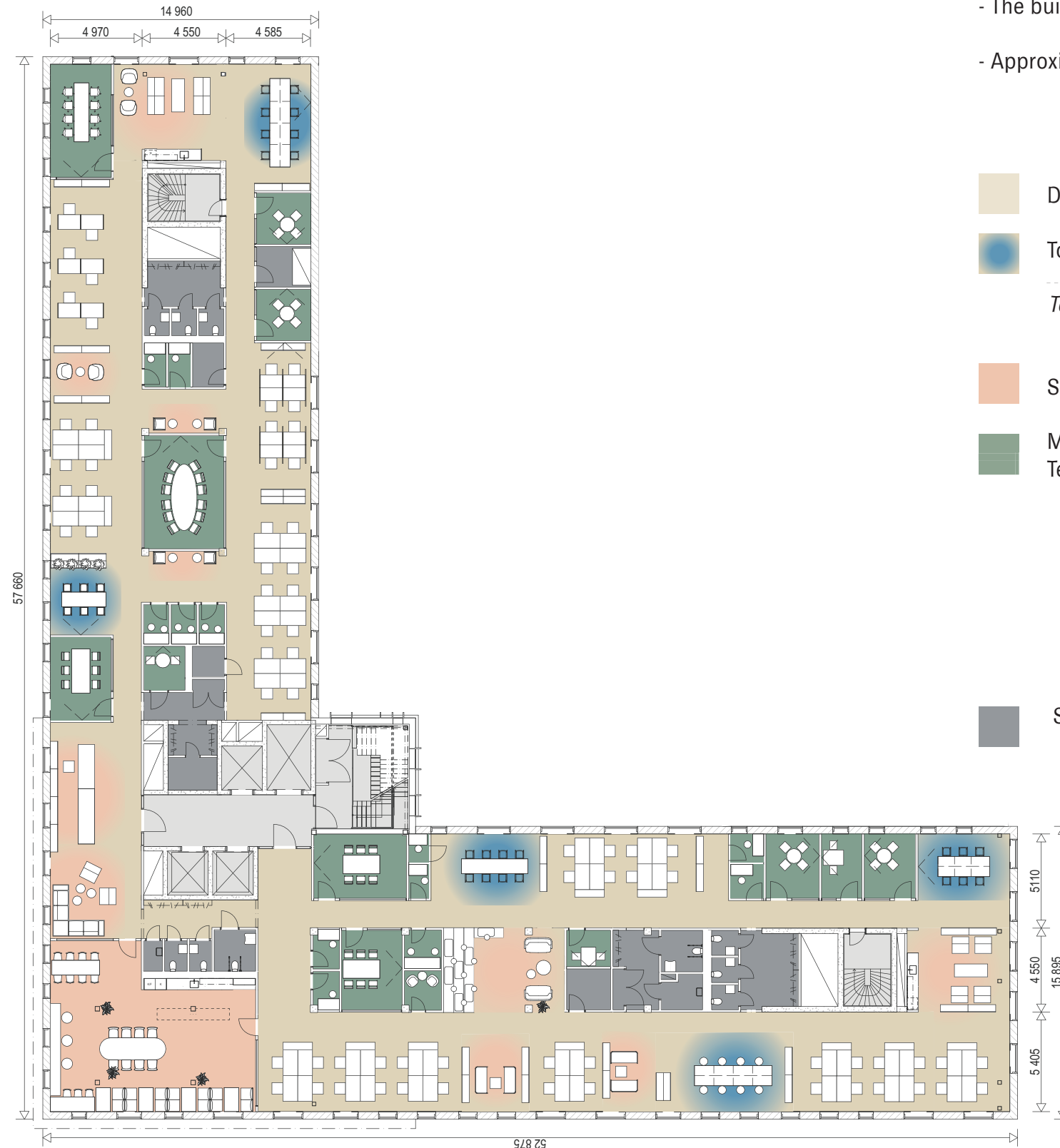

FLOOR 4, 5, 6, 7

LAYOUT EXAMPLE, SCANDINAVIAN STYLE

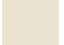

COLOR CODE AND FUNCTIONS

- Area 1242 sq.m.
- The building and each floor is dimensioned for a maximum of 10 sq.m./person
- Approximate room height: office landscape 2900 mm, circulation space/meeting room 2600 mm

	Desks in open plan	70 seats
	Touchdown seats	36 seats
<i>Total</i>		<i>106 seats</i>

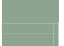
	Social area	77 seats
	Meeting rooms Telephone rooms	

12 seats	1 room
8 seats	1 room
6 seats	3 rooms
4 seats	4 rooms
2 seats	5 rooms
1 seat	11 rooms

 Service / WC (10) / Copy room (1) / Quiet room (1) / Kitchenette (1) / Coffee station (2)



SCALE 1:200

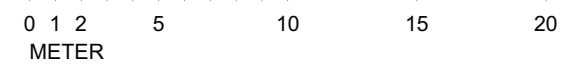

* The property owner reserves the right for changes, printing errors or incorrect information in this document. The floor plans are suggestions that may deviate from reality.

PORTALEN

BONNIER FASTIGHETER



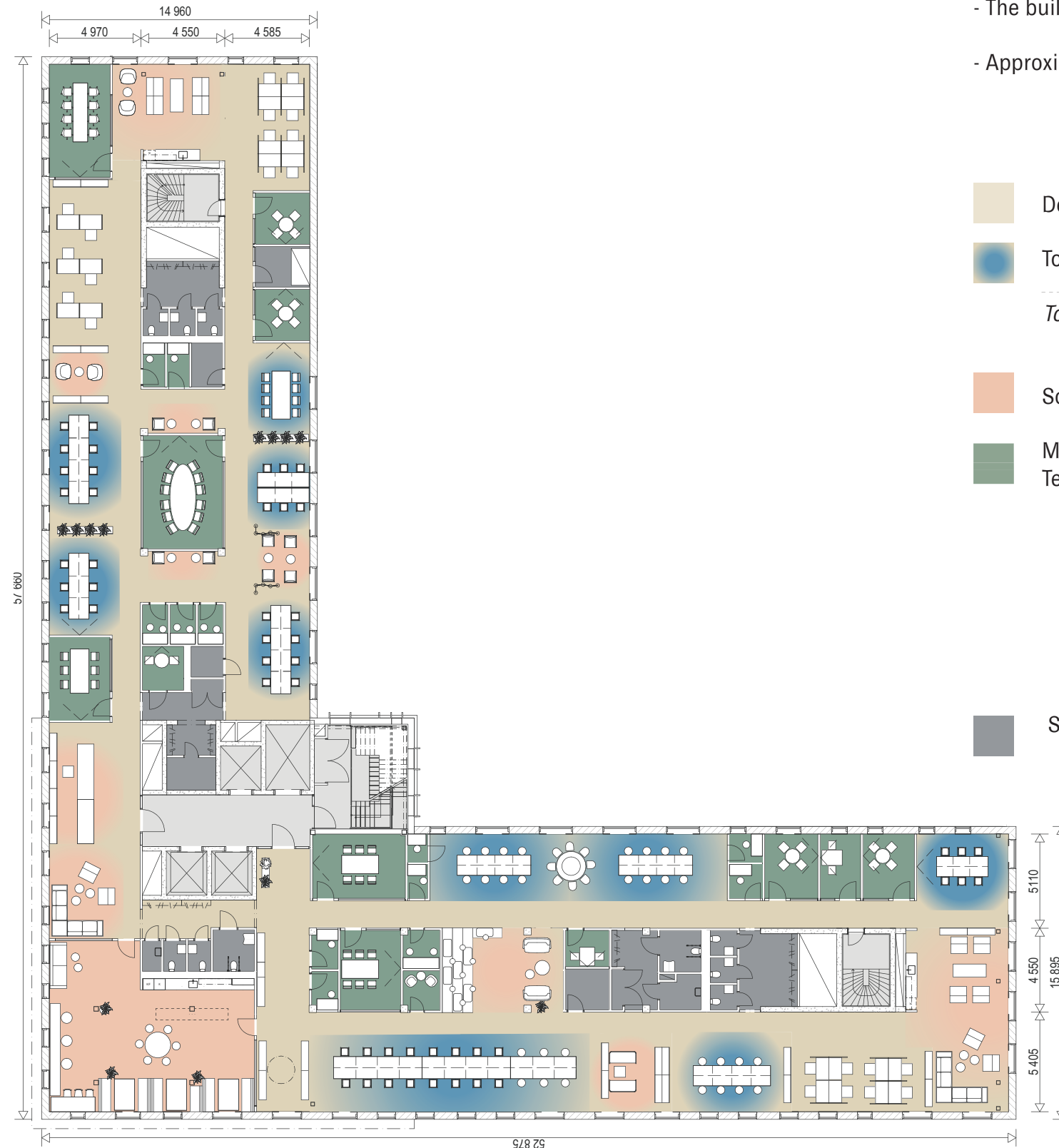

FLOOR 4, 5, 6, 7

LAYOUT EXAMPLE, INDUSTRIAL STYLE

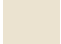

COLOR CODE AND FUNCTIONS

- Area 1242 sq.m.
- The building and each floor is dimensioned for a maximum of 10 sq.m./person
- Approximate room height: office landscape 2900 mm, circulation space/meeting room 2600 mm

	Desks in open plan	22 seats
	Touchdown seats	96 seats
<i>Total</i>		<i>118 seats</i>
	Social area	84 seats
	Meeting rooms	
	Telephone rooms	
	12 seats	1 room
	8 seats	1 room
	6 seats	3 rooms
	4 seats	4 rooms
	2 seats	5 rooms
	1 seat	11 rooms
	Service / WC (10) / Copy room (1) / Quiet room (1) / Kitchenette (1) / Coffee station (2)	



SCALE 1:200

0 1 2 5 10 15 20
METER

* The property owner reserves the right for changes, printing errors or incorrect information in this document. The floor plans are suggestions that may deviate from reality.

PORTALEN

BONNIER FASTIGHETER



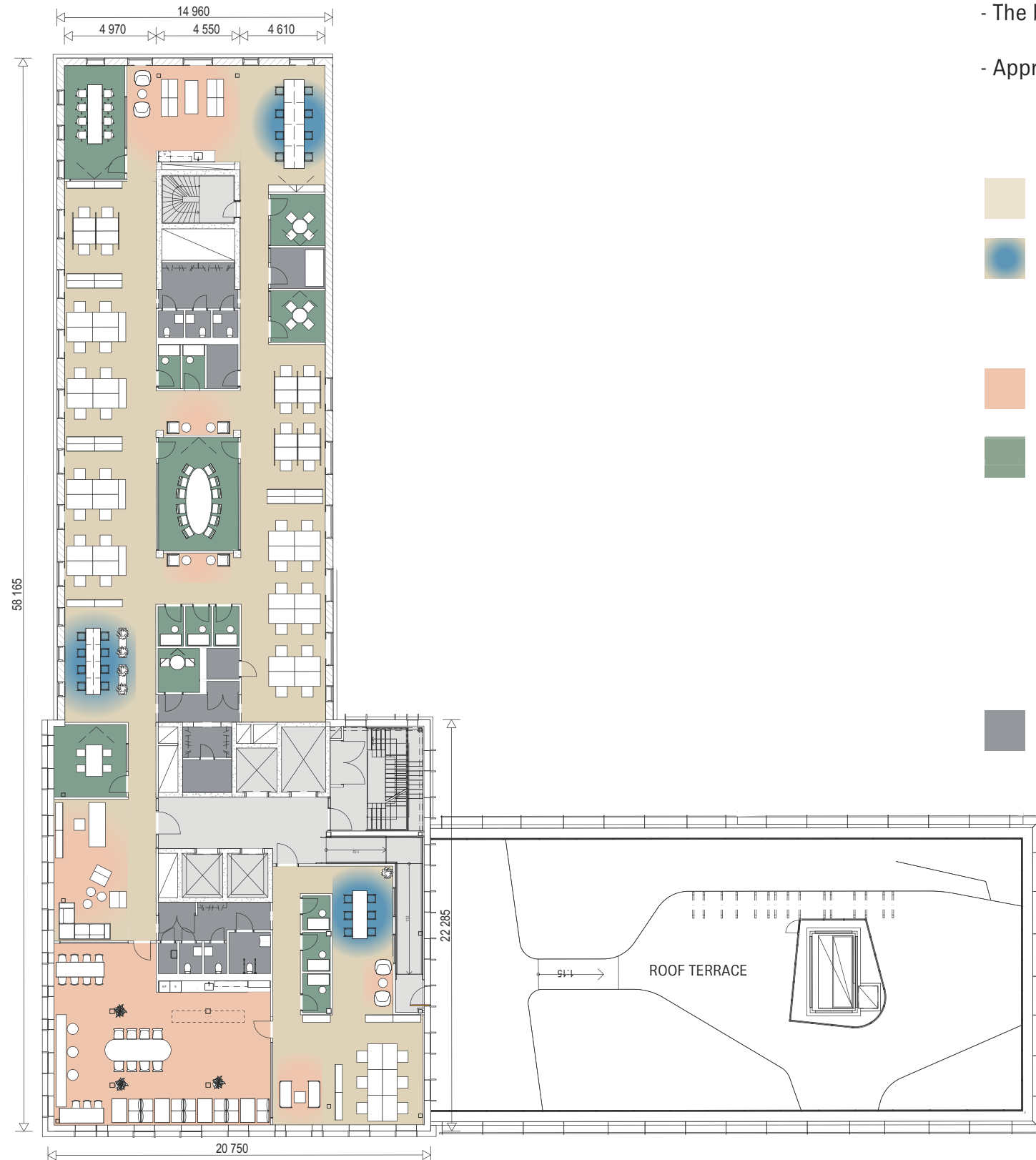

FLOOR 8

LAYOUT EXAMPLE, SCANDINAVIAN STYLE



COLOR CODE AND FUNCTIONS

- Area 785 sq.m.
- The building and each floor is dimensioned for a maximum of 10 sq.m./person
- Approximate room height: office landscape 2900 mm, circulation space/meeting room 2600 mm

	Desks in open plan	46 seats
	Touchdown seats	22 seats
<hr/>		
	<i>Total</i>	<i>68 seats</i>
	Sociala area	58 seats
	Meeting rooms	
	Telephone rooms	
	12 seats	1 room
	8 seats	1 room
	4 seats	3 rooms
	2 seats	1 room
	1 seat	8 rooms
	Service / WC (6) / Copy room (1) / Quiet room (1) / Kitchenette (1) / Coffee station (1)	



SCALE 1:200

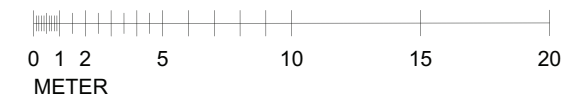

* The property owner reserves the right for changes, printing errors or incorrect information in this document. The floor plans are suggestions that may deviate from reality.

PORTALEN

BONNIER FASTIGHETER



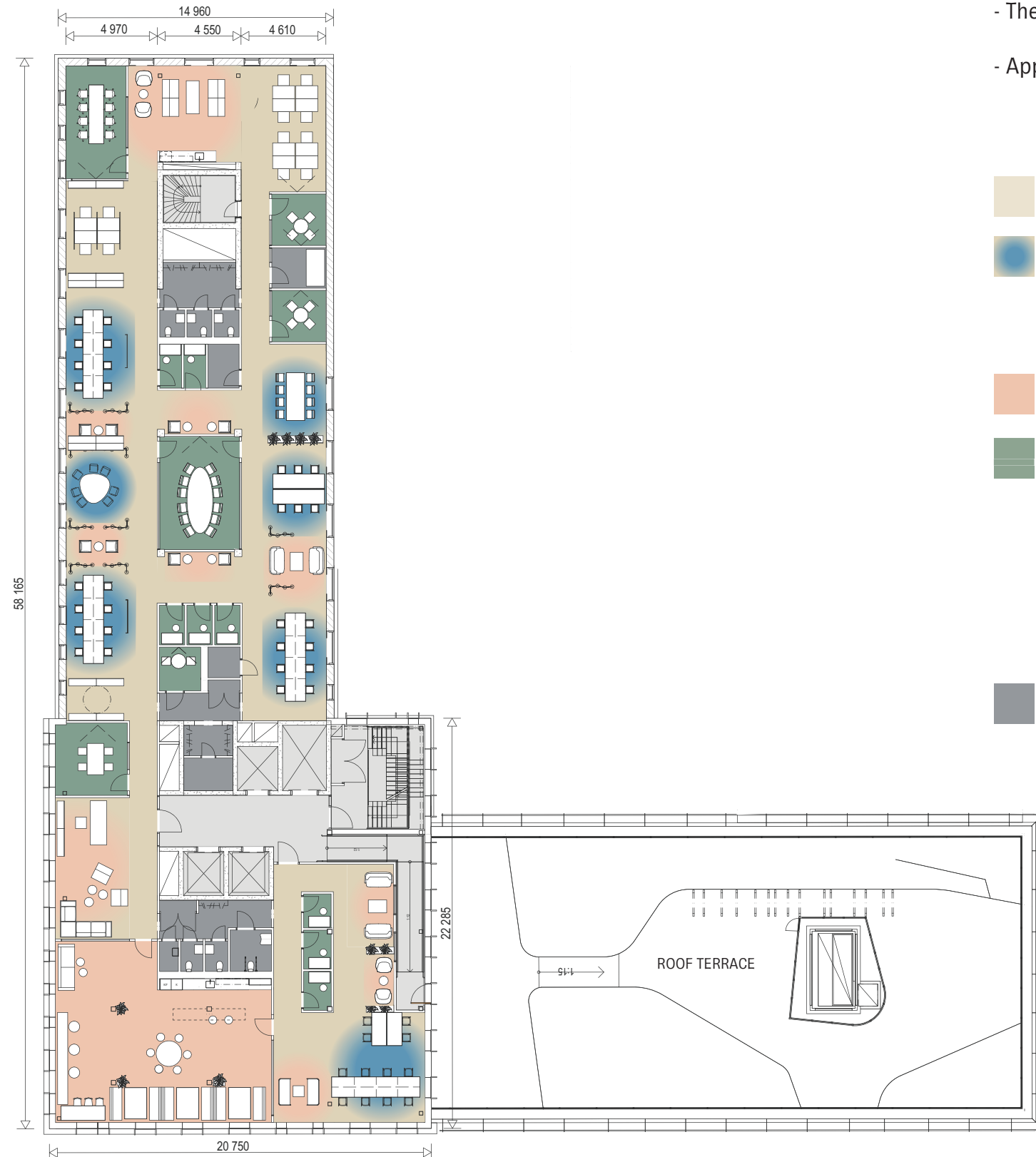

FLOOR 8

LAYOUT EXAMPLE, INDUSTRIAL STYLE

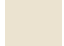

COLOR CODE AND FUNCTIONS

- Area 785 sq.m.
- The building and each floor is dimensioned for a maximum of 10 sq.m./person
- Approximate room height: office landscape 2900 mm, circulation space/meeting room 2600 mm

	Desks in open plan	12 seats
	Touchdown seats	57 seats
<hr/>		<i>Total</i>
		<i>69 seats</i>
	Social area	64 seats
	Meeting rooms	
	Telephone rooms	
		12 seats 1 room
		8 seats 1 room
		4 seats 3 rooms
		2 seats 1 room
		1 seat 8 rooms
	Service / WC (6) / Copy room (1) / Quiet room (1) / Kitchenette (1) / Coffee station (1)	



SCALE 1:200

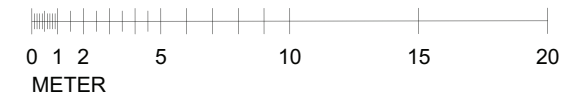

PORTALEN

BONNIER FASTIGHETER

FLOOR 9

LAYOUT EXAMPLE, SCANDINAVIAN STYLE

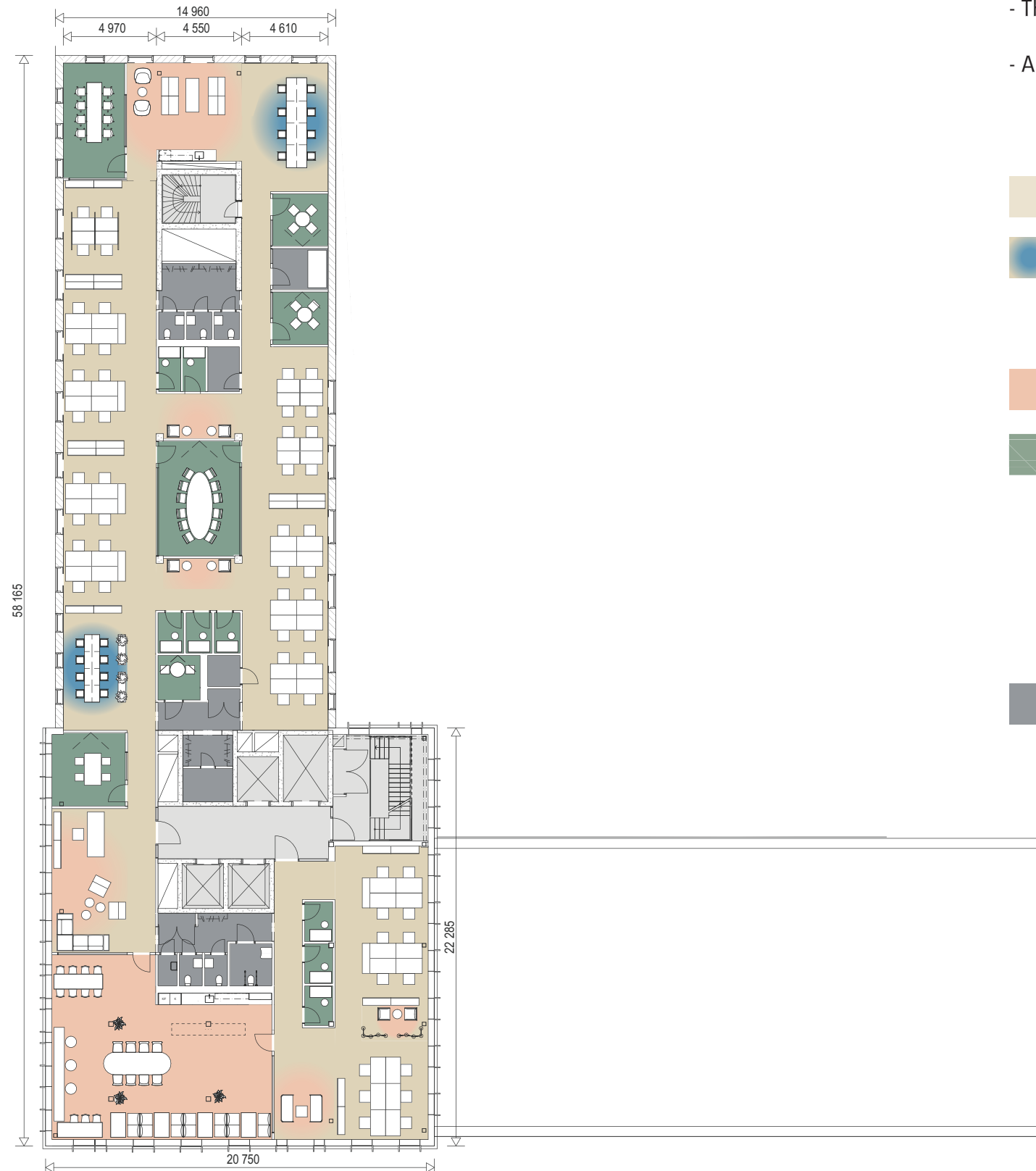

COLOR CODE AND FUNCTIONS

- Area 810 sq.m.
- The building and each floor is dimensioned for a maximum of 10 sq.m./person
- Approximate room height: office landscape 2900 mm, circulation space/meeting room 2600 mm

	Desks in open plan	54 seats
	Touchdown seats	16 seats
		<i>Total</i>
		<i>70 seats</i>
	Social area	58 seats
	Meeting rooms	
	Telephone rooms	
	12 seats	1 room
	8 seats	1 room
	4 seats	3 rooms
	2 seats	1 room
	1 seat	8 rooms
	Service / WC (6) / Copy room (1) / Quiet room (1) / Kitchenette (1) / Coffee station (1)	

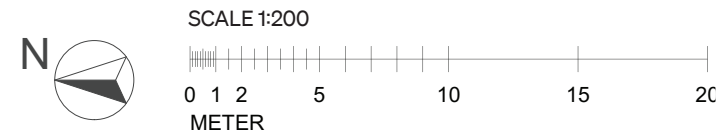

* The property owner reserves the right for changes, printing errors or incorrect information in this document. The floor plans are suggestions that may deviate from reality.

PORTALEN

BONNIER FASTIGHETER

FLOOR 9

LAYOUT EXAMPLE, INDUSTRIAL STYLE

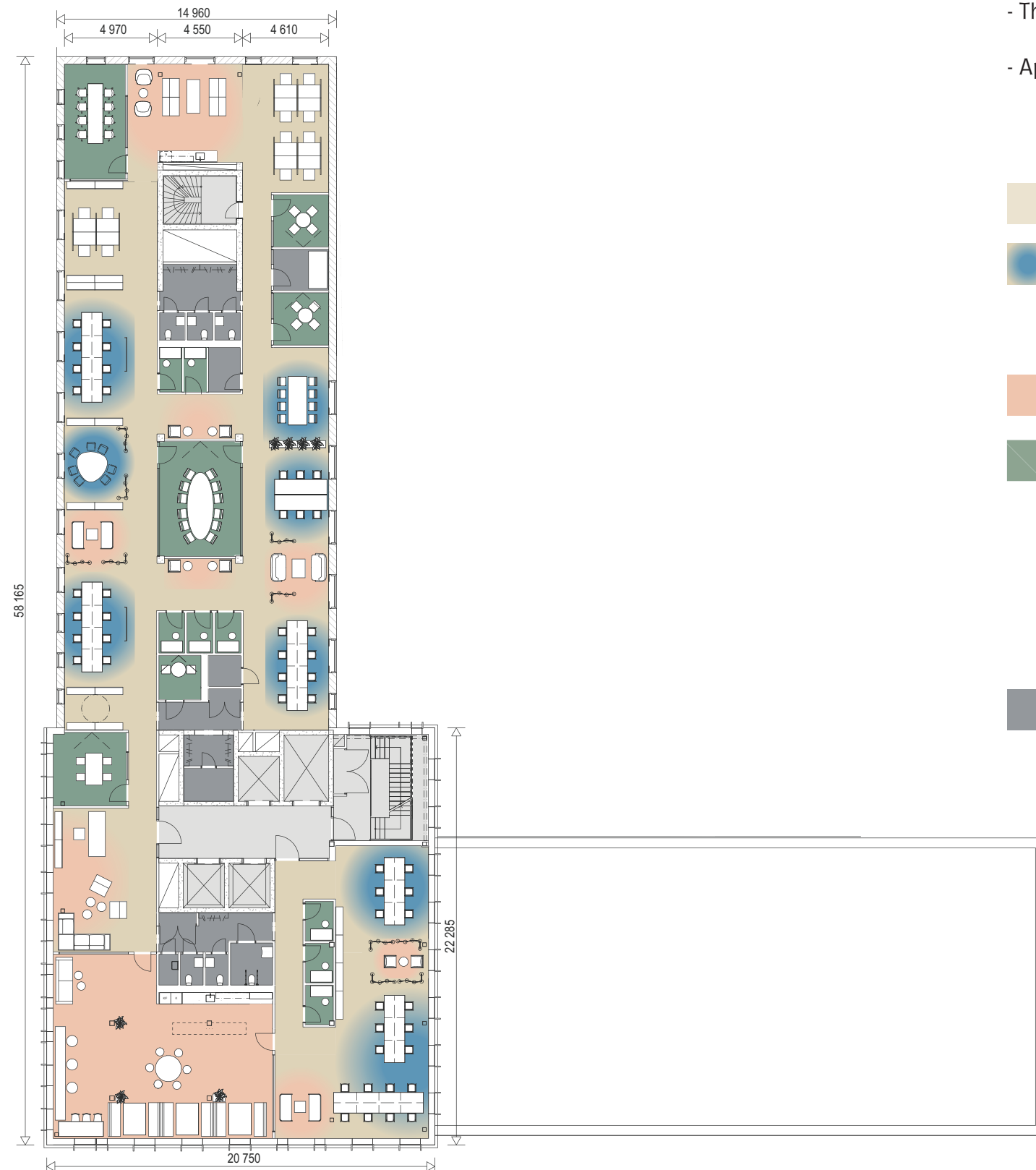

COLOR CODE AND FUNCTIONS

- Area 810 sq.m.
- The building and each floor is dimensioned for a maximum of 10 sq.m./person
- Approximate room height: office landscape 2900 mm, circulation space/meeting room 2600 mm

	Desks in open plan	12 seats
	Touchdown seats	65 seats
<i>Total</i>		<i>77 seats</i>
<hr style="border-top: 1px dashed #000;"/>		
	Social area	62 seats
	Meeting rooms	
	Telephone rooms	
	12 seats	1 room
	8 seats	1 room
	4 seats	3 rooms
	2 seats	1 room
	1 seat	8 rooms
	Service / WC (6) / Copy room (1) / Quiet room (1) / Kitchenette (1) / Coffee station (1)	



SCALE 1:200

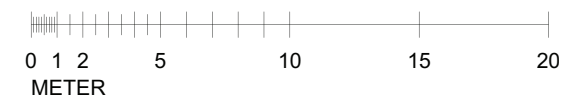

* The property owner reserves the right for changes, printing errors or incorrect information in this document. The floor plans are suggestions that may deviate from reality.

PORTALEN

BONNIER FASTIGHETER

FLOOR 10

LAYOUT EXAMPLE, SCANDINAVIAN STYLE

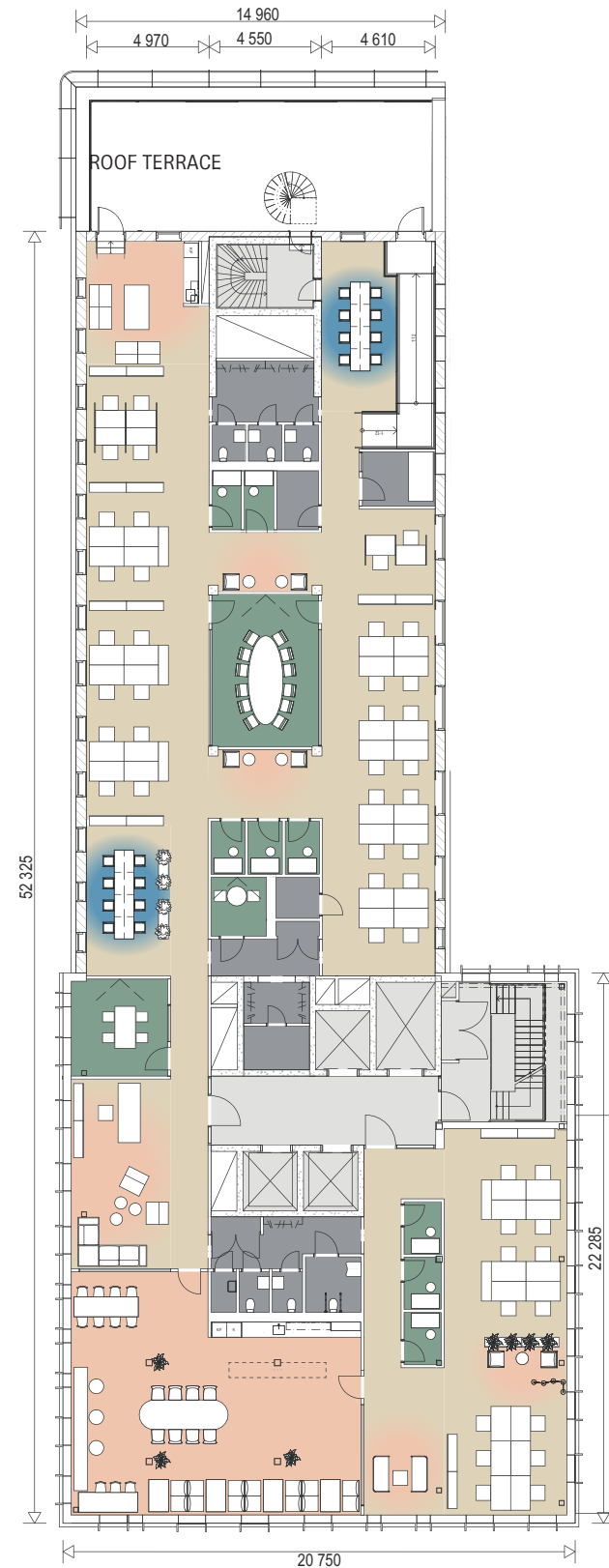

COLOR CODE AND FUNCTIONS

- Area 729 sq.m.
- The building and each floor is dimensioned for a maximum of 10 sq.m./person
- Approximate room height: office landscape 2900 mm, circulation space/meeting room 2600 mm

	Desks in open plan	48 seats
	Touchdown seats	16 seats
<i>Total</i>		<i>64 seats</i>
<hr/>		
	Social area	56 seats
	Meeting rooms Telephone rooms	
	12 seats	1 room
	4 seats	1 room
	2 seats	1 room
	1 seat	8 rooms
	Service / WC (6) / Copy room (1) / Quiet room (1) / Kitchenette (1) / Coffee station (1)	



SCALE 1:200

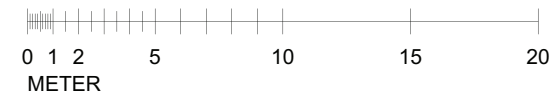

* The property owner reserves the right for changes, printing errors or incorrect information in this document. The floor plans are suggestions that may deviate from reality.

PORTALEN

BONNIER FASTIGHETER

FLOOR 10

LAYOUT EXAMPLE, INDUSTRIAL STYLE

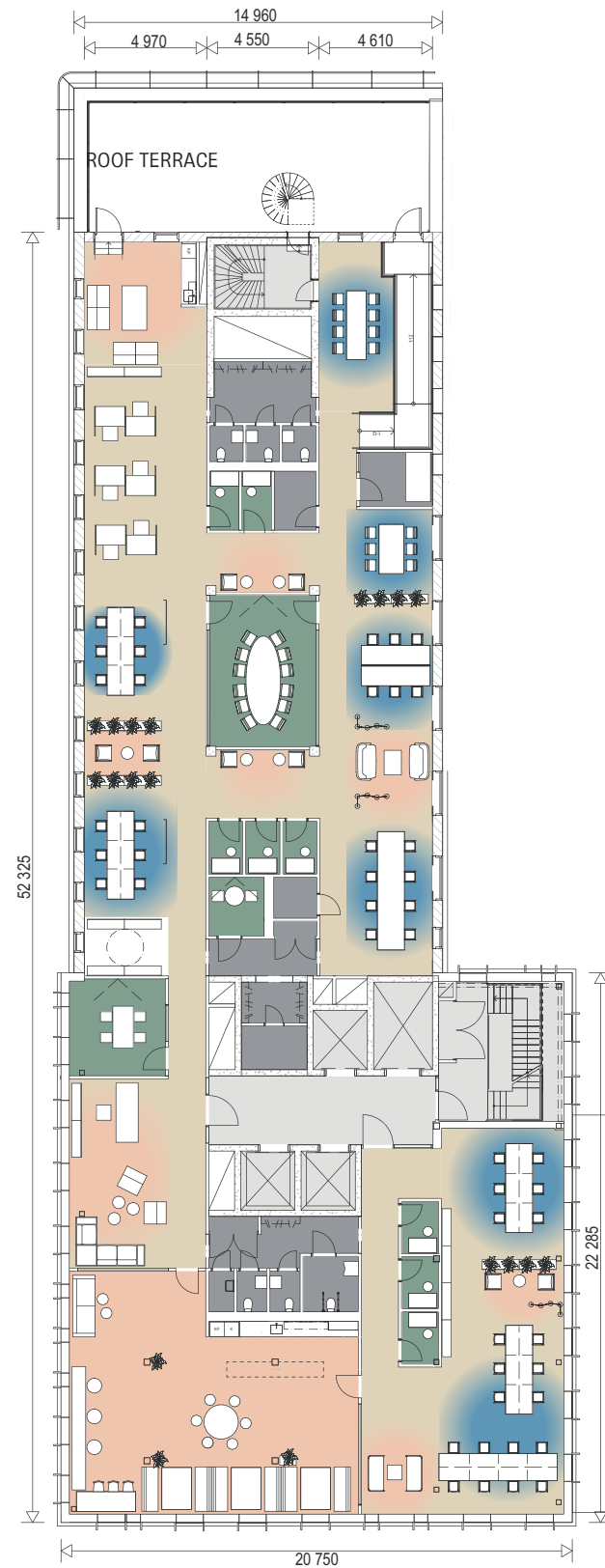

COLOR CODE AND FUNCTIONS

- Area 729 sq.m.
- The building and each floor is dimensioned for a maximum of 10 sq.m./person
- Approximate room height: office landscape 2900 mm, circulation space/meeting room 2600 mm

	Desks in open plan	6 seats
	Touchdown seats	60 seats
<i>Total</i>		<i>66 seats</i>
<hr/>		
	Social area	58 seats
	Meeting rooms	
	Telephone rooms	
	12 seats	1 room
	4 seats	1 room
	2 seats	1 room
	1 seat	8 rooms
	Service / WC (6) / Copy room (1) / Quiet room (1) / Kitchenette (1) / Coffee station (1)	

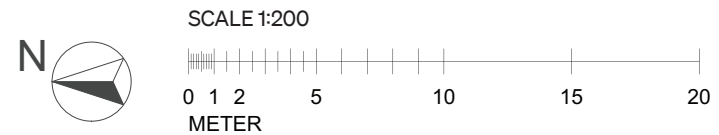

* The property owner reserves the right for changes, printing errors or incorrect information in this document. The floor plans are suggestions that may deviate from reality.

PORTALEN

BONNIER FASTIGHETER

FLOOR 11

LAYOUT EXAMPLE, SCANDINAVIAN STYLE

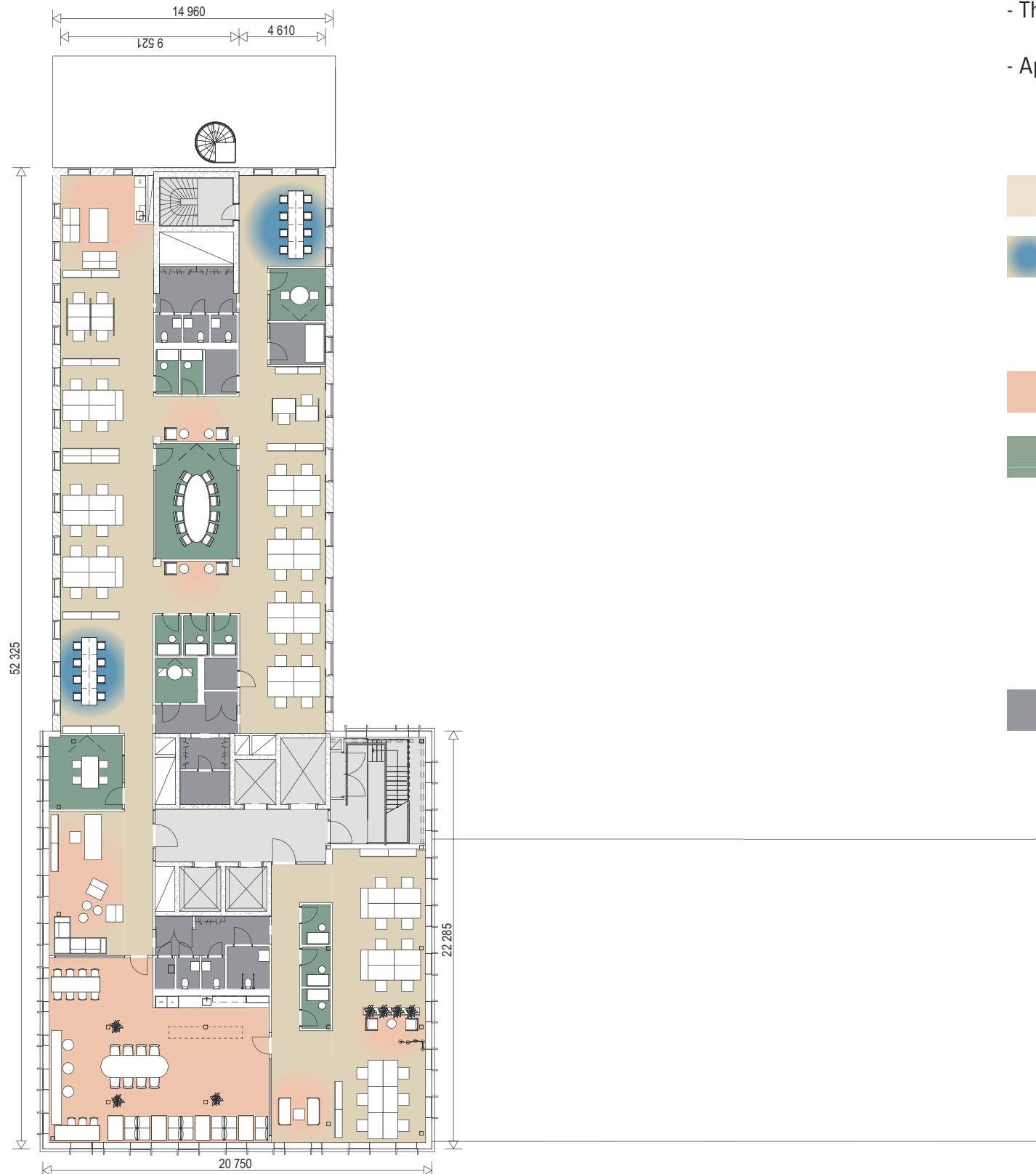

COLOR CODE AND FUNCTIONS

- Area 729 sq.m.
- The building and each floor is dimensioned for a maximum of 10 sq.m./person
- Approximate room height: office landscape 2900 mm, circulation space/meeting room 2600 mm

	Desks in open plan	48 seats
	Touchdown seats	16 seats

<i>Total</i>		<i>64 seats</i>
	Social area	55 seats
	Meeting rooms	
	Telephone rooms	
	12 seats	1 room
	4 seats	1 room
	2 seats	2 rooms
	1 seat	8 rooms
	Service / WC (6) / Copy room (1) / Quiet room (1) / Kitchenette (1) / Coffee station (1)	

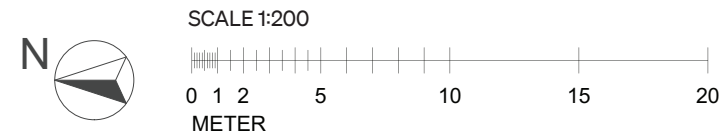

* The property owner reserves the right for changes, printing errors or incorrect information in this document. The floor plans are suggestions that may deviate from reality.

PORTALEN

BONNIER FASTIGHETER



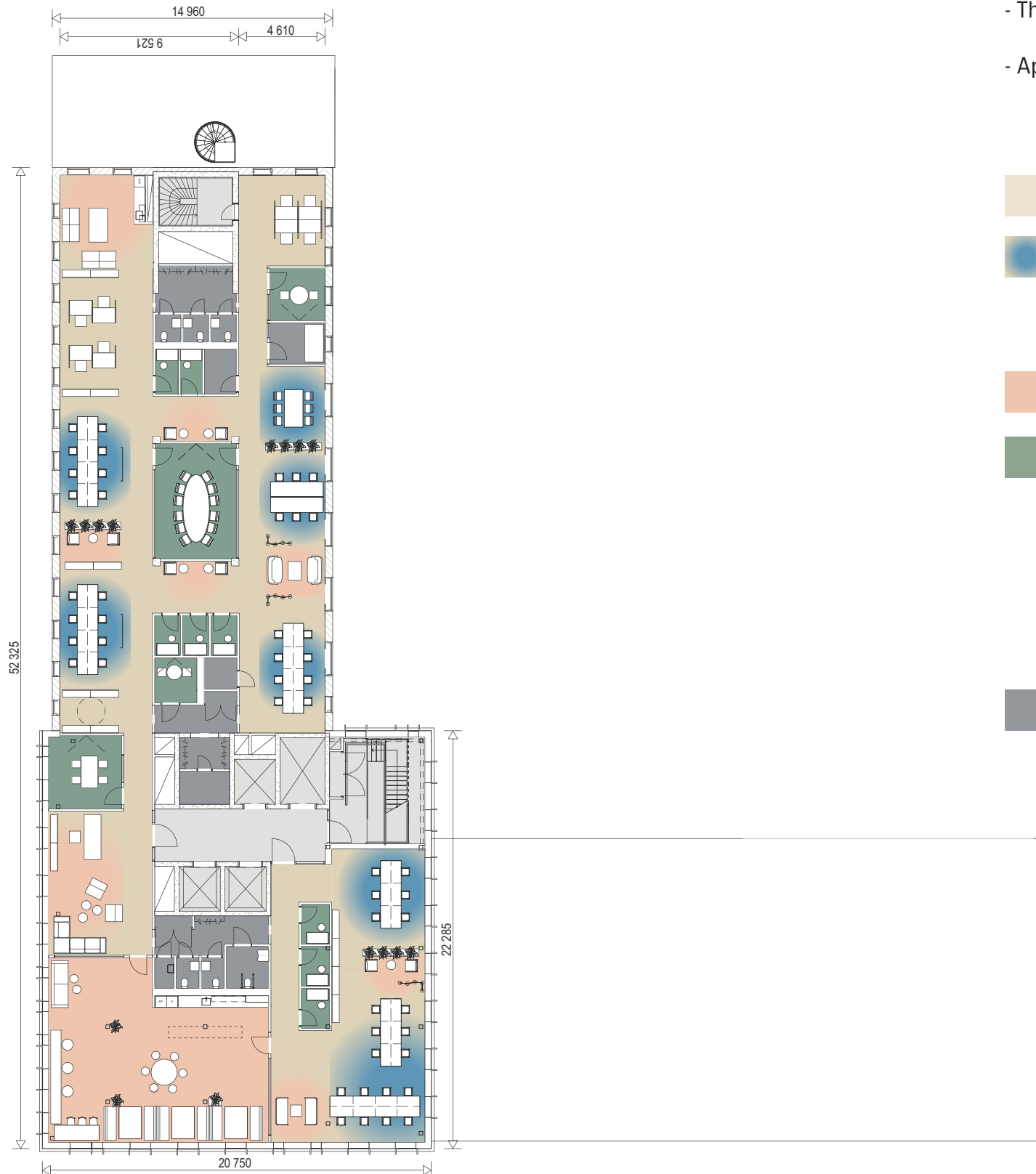

FLOOR 11

LAYOUT EXAMPLE, INDUSTRIAL STYLE

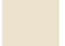

COLOR CODE AND FUNCTIONS

- Area 729 sq.m.
- The building and each floor is dimensioned for a maximum of 10 sq.m./person
- Approximate room height: office landscape 2900 mm, circulation space/meeting room 2600 mm

	Desks in open plan	8 seats
	Touchdown seats	56 seats
<i>Total</i>		<i>64 seats</i>
	Social area	58 seats
	Meeting rooms Telephone rooms	
	12 seats	1 room
	4 seats	1 room
	2 seats	2 rooms
	1 seat	8 rooms
	Service / WC (6) / Copy room (1) / Quiet room (1) / Kitchenette (1) / Coffee station (1)	

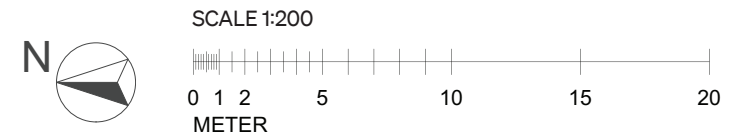

* The property owner reserves the right for changes, printing errors or incorrect information in this document. The floor plans are suggestions that may deviate from reality.

PORTALEN

BONNIER FASTIGHETER

FLOOR 12

LAYOUT EXAMPLE, SCANDINAVIAN STYLE

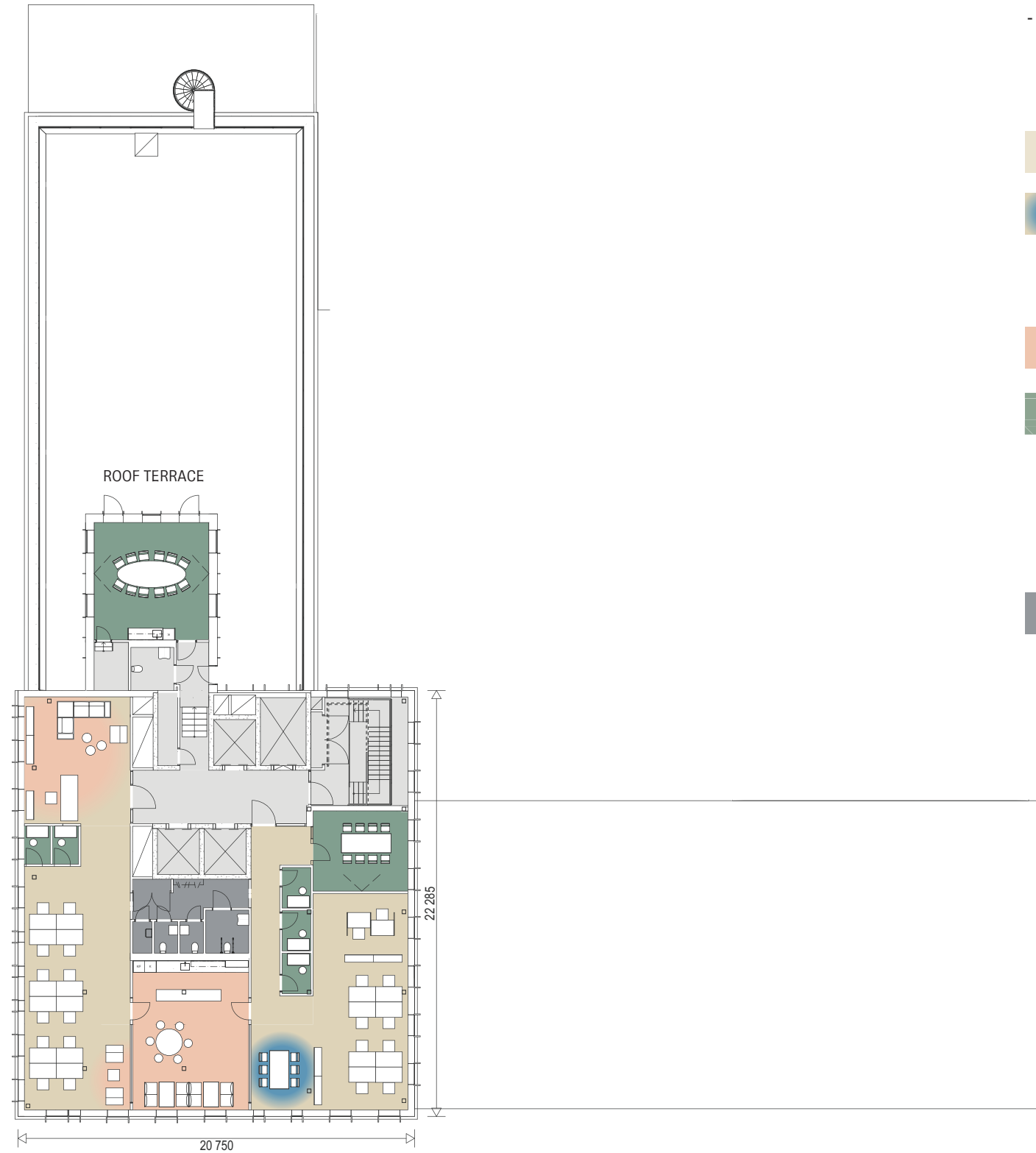

COLOR CODE AND FUNCTIONS

- Area 365 sq.m.
- The building and each floor is dimensioned for a maximum of 10 sq.m./person
- Approximate room height: office landscape 2900 mm, circulation space/meeting room 2600 mm

	Desks in open plan	22 seats
	Touchdown seats	6 seats
		<i>Total</i>
		<i>28 seats</i>
	Social area	20 seats
	Meeting rooms	
	Telephone rooms	
	12 seats	1 room (common meeting place with associated service functions)
	4 seats	1 room
	1 seat	5 rooms
	Service / WC (6) / Copy room (1) / Quiet room (1) / Kitchenette (1) / Coffee station (1)	

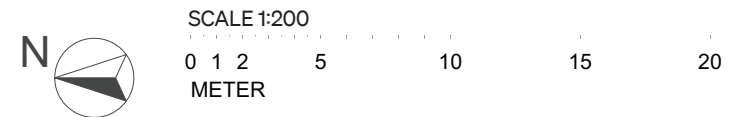

* The property owner reserves the right for changes, printing errors or incorrect information in this document. The floor plans are suggestions that may deviate from reality.

PORTALEN

BONNIER FASTIGHETER



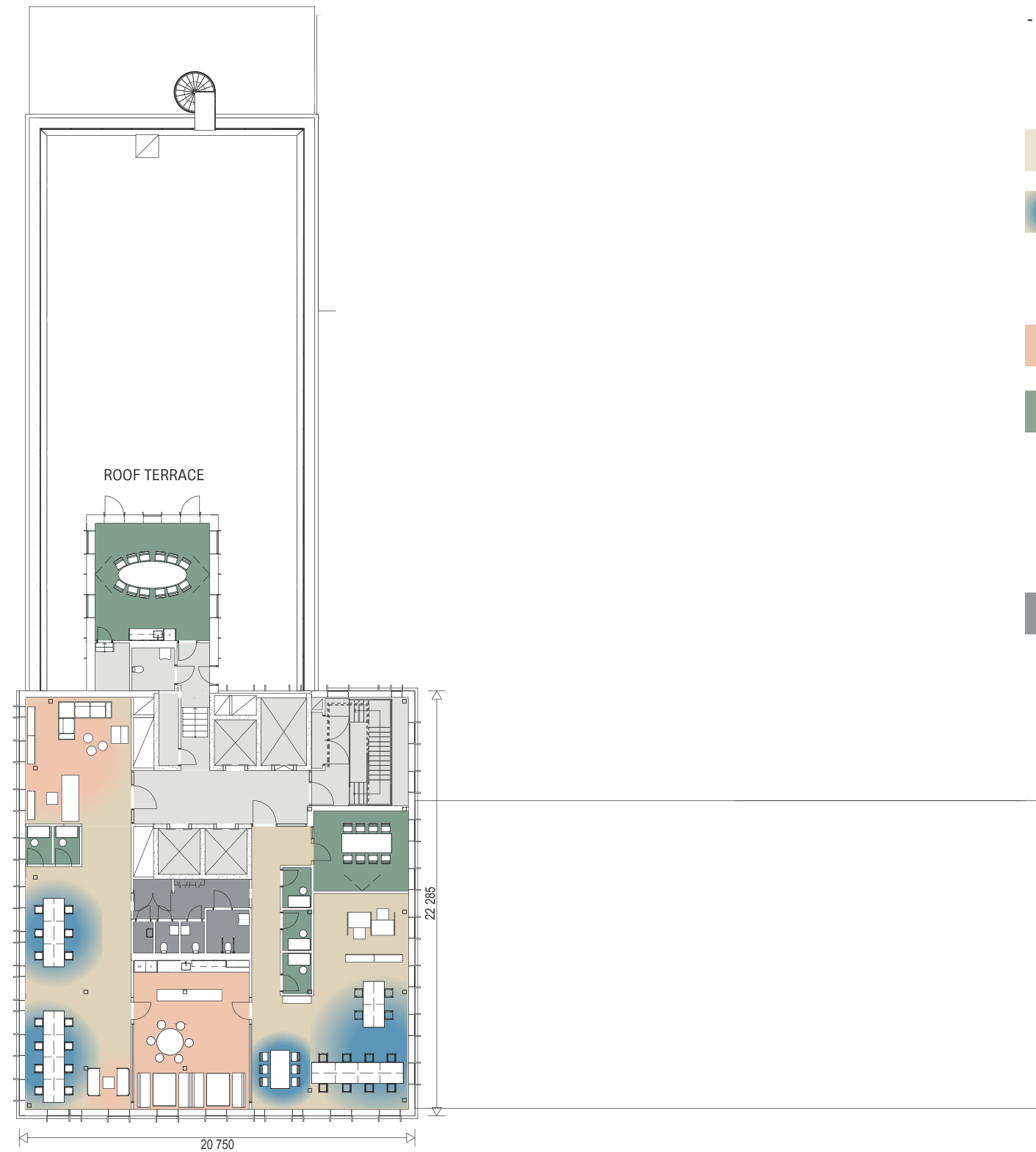

FLOOR 12

LAYOUT EXAMPLE, INDUSTRIAL STYLE

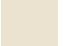

COLOR CODE AND FUNCTIONS

- Area 365 sq.m.
- The building and each floor is dimensioned for a maximum of 10 sq.m./person
- Approximate room height: office landscape 2900 mm, circulation space/meeting room 2600 mm

	Desks in open plan	2 seats
	Touchdown seats	32 seats
<i>Total</i>		<i>34 seats</i>
	Social area	26 seats
	Meeting rooms	
	Telephone rooms	
		12 seats
		4 seats
		1 seat
		1 room (common meeting place with associated service functions)
		1 room
		5 rooms
	Service / WC (6) / Copy room (1) / Quiet room (1) / Kitchenette (1) / Coffee station (1)	

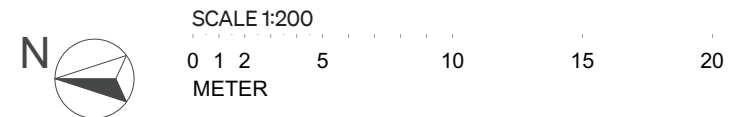

* The property owner reserves the right for changes, printing errors or incorrect information in this document. The floor plans are suggestions that may deviate from reality.